

LIVE STOCK AND DAIRY 30X50M

- Total Stall - 43nos
- 1. 9X6M = 54m² (4nos)
 - 1. 6X6M = 36m² (2nos)
 - 2. 6X3M = 18m² (6nos)
 - 3. 5X3M = 15m² (4nos)
 - 4. 4X3M = 12m² (5nos)
 - 5. 3X3M = 09m² (22nos)

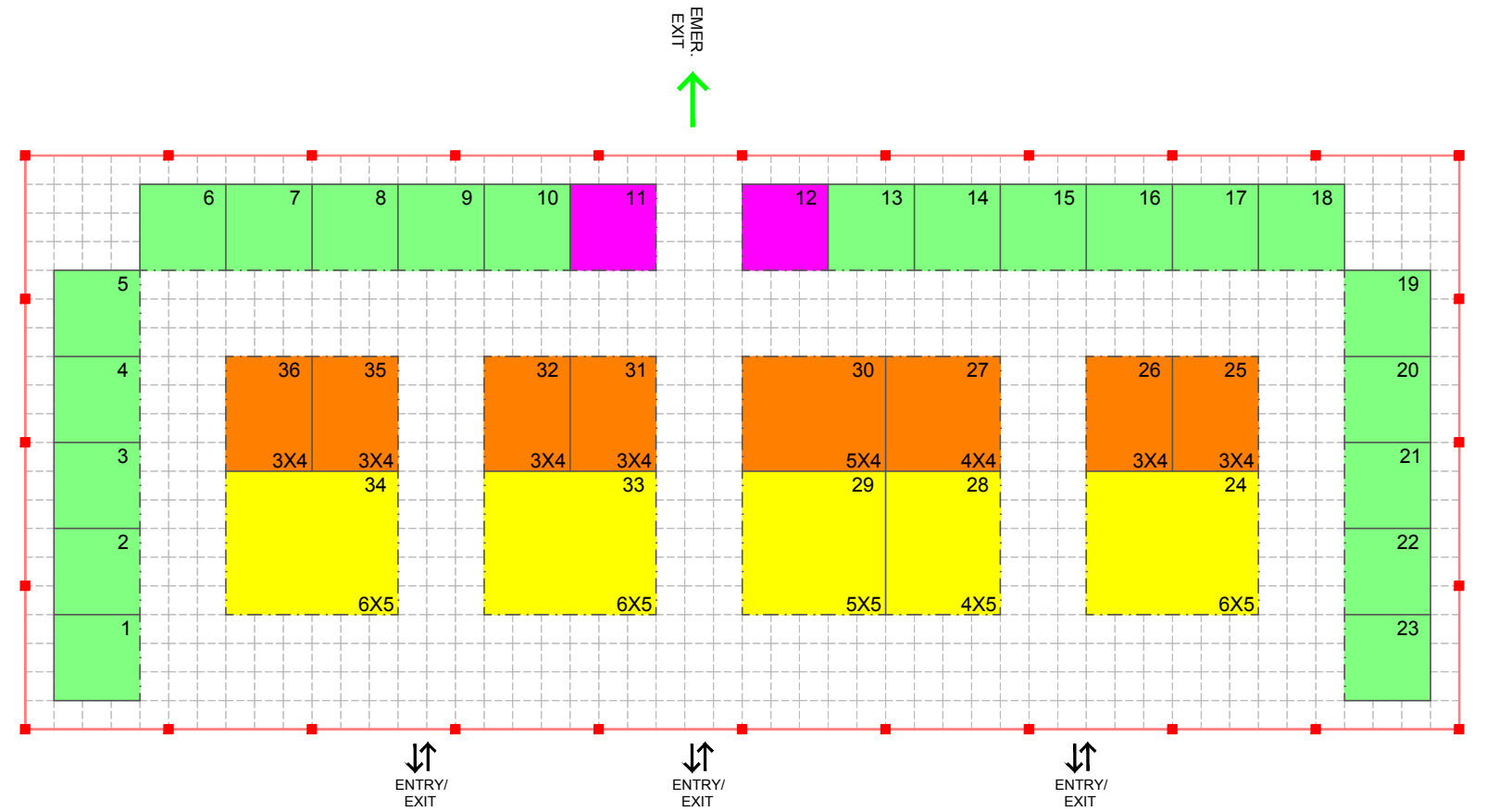

HANGAR 20X50M

HORTICULTURE AND FLORICULTURE

- Total Stall - 36nos
- 1. 6X5M = 30m² (3nos)
 - 1. 5X5M = 25m² (1nos)
 - 2. 5X4M = 20m² (2nos)
 - 3. 4X4M = 16m² (1nos)
 - 4. 3X4M = 12m² (6nos)
 - 5. 3X3M = 09m² (23nos)

LEGENDS

- PREMIUM BARE SPACE
- BARE SPACE
- SHELL SCHEME MORE THAN ONE SIDE OPEN
- SHELL SCHEME ONE SIDE OPEN

- EMERGENCY EXIT
- PAVILIONS ENTRY

- NOTES: 1.GRID 1X1MTRS.
2.ALL STALLS ARE 3X3M, OTHERWISE NOTED.
3.DOTTED LINES INDICATES THE OPEN SIDE OF STALL.